

PIC Wire & Cable

A Division of the Angelus Corporation
 Ph (262) 246-0500 Fax (262) 246-0450 www.picwire.com
 PO Box 330 Sussex, WI 53089

Connector Specification

Approved : 
 Distribution : USER

P/N 190521

Date 04/10/97
 Rev. 7 (06/18/14)
 Uncontrolled Document

TNC Bulkhead Jack
 for S67163

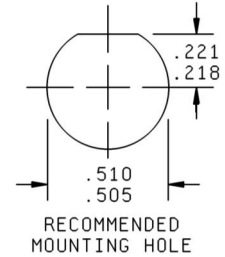
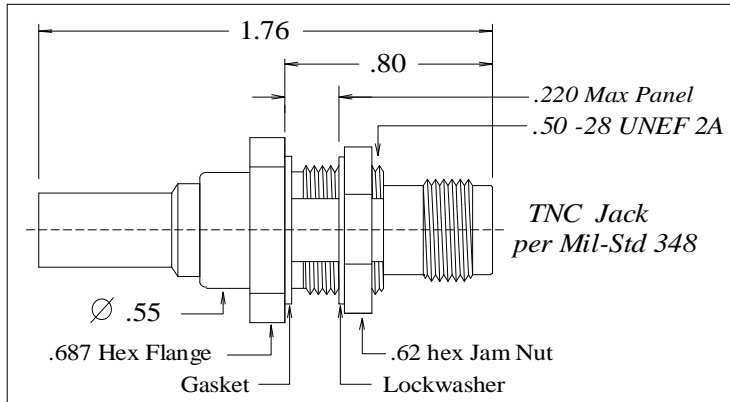
**PERFORMANCE**

Nominal Impedance	50 Ohms
Frequency Range	0 - 12 GHz
Voltage Rating	500 VRMS
Insulation Resistance	5000 Megohms

CONNECTOR WEIGHT (Each)

.96 ounces (27.22 grams)

RoHS COMPLIANT

Complies to RoHS Standards

INSTALLATION

Recommended Jam Nut Torque - 35 to 40 in. lbs.

Pic Die Set	MIL Spec Die Set
Center Contact	Center Contact
M22520 / 5 - 01 Tool,	M22520 / 5-01 Tool,
*PIC 190518A Hex Crimp Die	MIL Spec *M22520 / 5-57
(.098 hex)	(.100 B hex)
Crimp Ferrule	Crimp Ferrule
M22520 / 5 - 01 Tool,	M22520 / 5-01 Tool,
*PIC 190518A Hex Crimp Die	MIL Spec *M22520 / 5-43
(.270/.340 hex)	(.268 A hex)

CONSTRUCTION**Materials:**

Body	Brass, ASTM-B16, Alloy UNS 36000, H02
Center Contact	Beryllium Copper, ASTM-B196, Alloy UNS C17300
Ferrule	Brass, ASTM-B16, Alloy UNS 36000, Dead Soft, Weatherseals included
Dielectric	TFE Fluorocarbon, ASTM-D1710, Type 1, Grade 1
Hardware	Jam Nut, Lk WWshr, Grommet

Finish :

Body, Ferrule	Nickel
Center Contact	Gold

Applicable Standards	MIL-STD 348 MIL-PRF-39012
-----------------------------	------------------------------

Notes :

- 1) A 2.5" piece of Raychem ATUM heat shrink P/N ATUM-16/4-0 provided with connector for purpose of strain relief & moisture protection.
- 2) Please refer to T-190XXX Termination Instruction sheet for strip dimensions & instructions.

* Notes: 1. PIC 190518 Crimp Die Set superceded by PIC 190518A; either is acceptable for use with 190521 Connectors.
 2. MIL Spec die to be used on the smaller diameter area of ferrule only. Not the larger "Bell" area on end.

PIC Wire & Cable Connector User specification sheets are non-controlled documents. Please contact PIC Wire and Cable or visit the PIC website (www.picwire.com) to ensure the latest revision of the drawing is being viewed.