

PIC Wire & Cable	Connector Specification	P/N 150164
<i>A Division of the Angelus Corporation</i> Ph (262) 246-0500 Fax (262) 246-0450 www.picwire.com N220 W1051 Springdale Road, Waukesha, WI 53186	Approved : <i>FMB</i>	Date : 10/12/18
	Distribution : USER	Rev : 1 (06/21/22)
		Uncontrolled if Printed

D-Sub Size 8 Socket (Receptacle) Contact

for UH44193

Note : Use with PIC PN 150163 Pin Contact Only

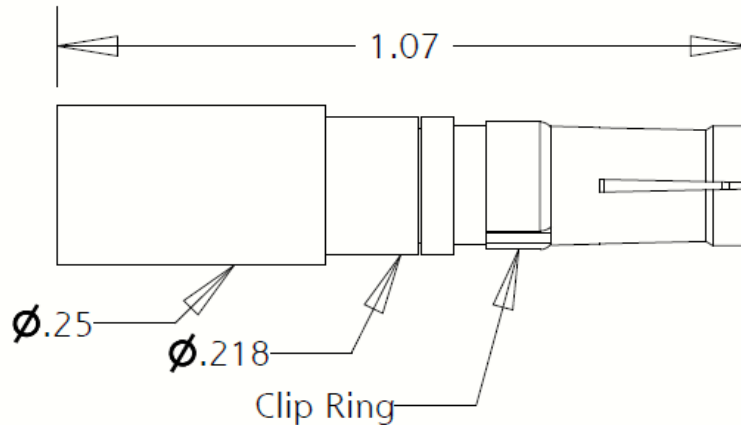

PERFORMANCE

Nominal Impedance : Non-Constant
 Frequency Range : 0 - 2 GHz
 Insertion Loss (max) : 0.5 dB @ 2 GHz.
 Voltage Rating : 1000 V(rms)
 Insulation Resistance : 5000 Megohms min.
 DW Voltage : 1500 V(rms)

CONNECTOR WEIGHT (Each)

0.15 oz (4.31 grams)

RoHS COMPLIANT

Complies to RoHS Standards

INSTALLATION (Tooling)

Center Contact :

M22520/2-01 Tool, selector dial @ #8
 Positioner: PIC PN 110245 (Daniels K426)

Crimp Ferrule :

M22520 / 5-01 Tool
 M22520 / 5-03 Die Set
 (.213" A hex)

CONSTRUCTION

Materials:

Body	Beryllium Copper, ASTM-B196, Alloy UNS C17300
Center Contact	Brass, ASTM-B16, Alloy UNS 36000, H02
Ferrule	Brass, ASTM-B16, Alloy UNS 36000, Dead Soft
Dielectric	PTFE Fluorocarbon, ASTM-D1457
Clip Ring	Beryllium Copper, ASTM-B194

Finish :

Body, Contact, Ferrule	Gold, MIL-G-45204
Clip Ring	Nickel, QQ-N-290

APPLICABLE STANDARDS

IDS-15

Notes :

1) Please refer to T-150164 Termination Instruction sheet for strip dimensions & instructions.

2) Recommended Removal Tools :

Palco P/N T0100-K, Positronics P/N 4311-0-0-0
 or ITT P/N CET-C6B