

A Division of the Angelus Corporation
 Ph (262) 246-0500 Fax (262) 246-0450 www.picwire.com
 PO Box 330 Sussex, WI 53089

Approved : 

Date : 10/30/03

Rev : 4 (09/07/18)

Distribution : USER

Uncontrolled if Printed

ARINC 600 Size 1 Socket Contact

for S65161, S65161-A

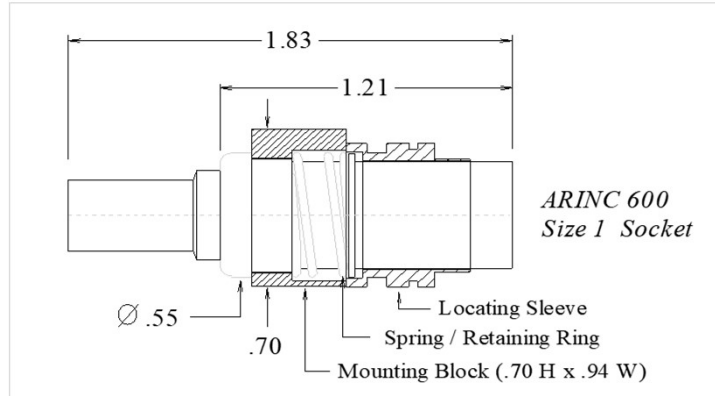

ARINC 600
Size 1 Socket

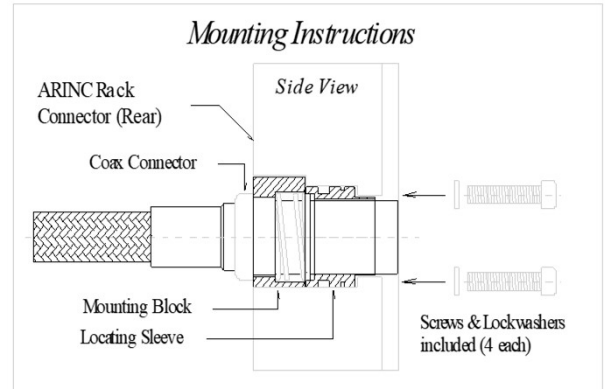

Features Not Shown : Mounting Screws (4 ea), Lockwashers (4 ea)

PERFORMANCE

Nominal Impedance	50 Ohms
Frequency Range	0 - 5 GHz
Voltage Rating	1000 V(rms)
Insulation Resistance	5000 Megohms
DWV	2500 V(rms)
VSWR (Max)	1.7:1
Insertion Loss (Max)	0.3 dB

CONNECTOR WEIGHT (Each)

1.39 ounces (39.41 grams)

RoHS COMPLIANT

Complies to RoHS Standards

INSTALLATION

Pic Die Set

Center Contact

M22520 / 5 - 01 Tool,
 PIC 190518A Hex Crimp Die
 (.098 hex)

Crimp Ferrule

M22520 / 5 - 01 Tool,
 PIC 190518A Hex Crimp Die
 (.270/.340 hex)

MIL Spec Die Set

Center Contact

M22520 / 5-01 Tool,
 MIL Spec *M22520 / 5-57
 (.100 B hex)

Crimp Ferrule

M22520 / 5-01 Tool,
 MIL Spec *M22520 / 5-43
 (.268 A hex)

CONSTRUCTION

Materials:

Body	Brass, ASTM-B16, Alloy UNS 36000, H02
Center Contact	Beryllium Copper, ASTM-B196, Alloy UNS C17300
Ferrule	Brass, ASTM-B16, Alloy UNS 36000, Dead Soft, Weatherseals included
Dielectric	TFE Fluorocarbon, ASTM-D1710, Type 1, Grade 1
Spring, Retaining Ring	Stainless Steel
Mounting Block	Aluminum, Alloy 6061 T6

Finish :

Body, Ferrule, Contact	Gold
Spring, Retaining Ring	Passivated
Mounting Block	Iridite

APPLICABLE STANDARDS

ARINC 600

Notes :

- 1) A 1.5" piece of Raychem ATUM heat shrink P/N ATUM-16/4-0 provided with connector for purpose of strain relief & moisture protection.
- 2) Please refer to T-1905XXA Termination Instruction sheet for strip dimensions & instructions.

* Note: MIL Spec die to be used on the smaller diameter area of ferrule only. Not the larger "Bell" area on end.